

Firestone
BUILDING PRODUCTS COMPANY

UNA-CLAD UC-6

STANDING SEAM PANEL FOR ARCHITECTURAL
AND STRUCTURAL METAL ROOFING

DESCRIPTION:

Firestone UNA-CLAD UC-6 Double-Lock Standing Seam roofing panel utilizes the proven seaming process of Pittsburgh Locking in conjunction with the floating action of a concealed clip assembly. This design allows for expansion & contraction caused by natural elements, providing a virtually leak proof roof with exceptional wind uplift ratings. The panel is available in a wide variety of materials and finishes including Kynar® coated G-90 Galvanized Steel, Galvalume® Steel, and Aluminum, as well as Copper and Zinc. An optional thermally-applied pre-assembly in-seam sealant is available. While the minimum slope requirement for a Firestone Red Shield Warranty is 3:12, the UC-6 panel can be installed on non-Red Shield projects down to 1:12.

METHOD OF APPLICATION:

1. Firestone UC-6 panels must be installed in a sequential pattern.
2. Application of a Firestone approved underlayment prior to panel installation is recommended when installed over a solid substrate.
3. Panels must be locked in the field by a mechanical seamer.

Note: Install assembly according to Firestone Metal Design and Application Guides found on the Firestone website. Follow approved installation details.

STORAGE:

1. Firestone metal panels should be stored in a well ventilated, dry place where no moisture can contact them. Moisture (from rain, snow, condensation, etc.) trapped between layers of material may cause water stains or white rust, which can affect the service life of the material and will detract from its appearance.
2. If outdoor storage cannot be avoided, protect the panels with a ventilated canvas or waterproof paper cover. Do not use plastic, which can cause condensation. Keep the material off the ground in an inclined position with an insulator such as wood. Protective film may degrade or become brittle with long term exposure to direct sunlight.

PRECAUTIONS:

1. Oil canning is not a cause for rejection.
2. Heavier gauges, narrower widths, striations, and embossing minimize oil canning.
3. Ensure the mechanical seamer is properly adjusted prior to field seaming to reduce the risk of seam damage.
4. Sealant for end laps and lap joints shall be non-drying, non-toxic, and non-shrinking with a serviceable temperature of -60 °F to 212 °F. (-51 to 100 °C)
5. Quality, long-life butyl sealants work best as a gasket sandwiched between two pieces of metal. Non-acetic cured silicone color matching sealants are recommended when voids must be filled. Sealants are not a substitute for proper assembly and workmanship.
6. Exercise caution when lifting, moving, transporting, storing or handling Firestone metal to avoid possible physical damage.
7. Refer to Material Safety Data Sheets (MSDS) for safety information.
8. Immediately remove protective film after installation.

FIRESTONE RED SHIELD WARRANTY AVAILABLE†

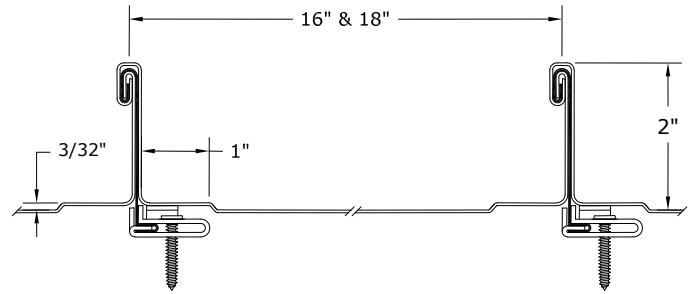

PRODUCT DATA

Panel Type:	Standing Seam
Panel Interlock:	Mechanical Double-Lock
Tapered Panels:	No*
Min. Red Shield Slope:	3:12
Radiused:	Yes*
Stiffening Ribs:	Optional*
Striations:	Optional*
Sealant:	Optional In-Seam, Thermally Applied†
Standard Panel Surface:	Smooth
Optional panel Surface:	Stucco Embossed
Clip:	UC-6 Low-Float Clip, UC-6 Super Clip, & UC-6 Fixed Clip
Substrate:	Solid Substrate or Steel Purlins†

PANEL SIZE

Panel Width:	8" - 24" (203.2 mm - 609.6 mm)
Optimal Panel Width:	18" (406.4 mm)
Seam Height:	2" (38.1 mm)
Min. Panel Length:	36" (914.4 mm)
Max. Panel Length:	600" (15,240 mm)

TECHNICAL INFORMATION

Uplift Resistance:	UL 580 Class 90
Air Infiltration:	ASTM E1680
Water Penetration:	ASTM E1646
Uniform Static Air Pressure:	ASTM E1592
Fire Rating:	UL Class A Rated Assemblies UL 263, UL 790
Hail Rating:	Class 4, UL 2218

*Not manufactured at all facilities.

†See the Firestone Metal Roof System Design Guide for Red Shield Warranty requirements.

Note: Testing not applicable for all substrates, materials, and dimensions. All systems with test listings must be installed in accordance with the assembly tested. Refer to Firestone Website for available code listings.



UNA-CLAD UC-6

STANDING SEAM PANEL FOR ARCHITECTURAL
AND STRUCTURAL METAL ROOFING

MATERIAL & THICKNESS	METAL SPECIFICATION	AVAILABLE FINISHES
ALUMINUM 0.032" (0.81 mm)	Base Metal: Aluminum Minimum Yield: 21 KSI (145 MPa) Thermal Expansion: 12.6×10^{-6} in/in/F° ($22.2 \text{ m/m.K} \times 10^{-6}$) Mod. Of Elasticity: 10.0×10^3 x KSI (68.9 MPa)	Anodized Kynar 500®/Hylar 5000® Unpainted/ Mill Finish
GALVANIZED STEEL 26 ga. (0.48 mm) 24 ga. (0.64 mm) 22 ga. (0.79 mm)	Base Metal: AISA-G90 Galvanized steel Minimum Yield: 33 to 45 KSI (227 to 310 MPa) Thermal Expansion: 06.7×10^{-6} in/in/F° ($13.9 \text{ m/m.K} \times 10^{-6}$) Mod. Of Elasticity: 29.0×10^6 x KSI (200 GPa)	Kynar 500®/Hylar 5000® Unpainted G90
GALVALUME® STEEL 24 ga. (0.64 mm)	Base Metal: AZ-50 Hot Dipped Galvalume Minimum Yield: 50 KSI (345 MPa) Thermal Expansion: 06.7×10^{-6} in/in/F° ($13.9 \text{ m/m.K} \times 10^{-6}$) Mod. Of Elasticity: 29.0×10^6 x KSI (200 GPa)	Kynar 500®/Hylar 5000®
GALVALUME STEEL 26 ga. (0.48mm) 24 ga. (0.64mm) 22 ga. (0.79mm)	Base Metal: AZ-55 Hot Dipped Galvalume Minimum Yield: 50 KSI (345 MPa) Thermal Expansion: 06.7×10^{-6} in/in/F° ($13.9 \text{ m/m.K} \times 10^{-6}$) Mod. Of Elasticity: 29.0×10^6 x KSI (200 GPa)	Acrylume – Clear Acrylic Coated
COPPER 16 oz (0.56 mm) 20 oz (0.69 mm)	AGSC minimum copper content of 99.9% copper, silver counting as copper, cold rolled from ingots of 122 alloy. Thermal Expansion: 9.3×10^{-6} in/in/F° ($16.5 \text{ m/m.K} \times 10^{-6}$) AGSC copper meets and/ or exceeds ASTM B370 specification.	Natural Patriot Green™ Freedom Gray™
ZINC 0.028" (0.7 mm) 0.032" (0.8 mm)	RHEINZINK®: Electrolytic high-grade, 99.995% pure, fine zinc (DIN EN 1179) titanium copper alloy. certified according to DIN ISO 9001: 1994 Thermal Expansion: $2.2 \text{ mm/m} \times 100\text{K} (\mathbf{16.5"} \times 10^{-6} \text{ in/in/F})$	Shiny Preweathered Blue-Gray Graphite Gray

Note: Consult current UNA-CLAD Color Selection Guide
Custom color services available upon request
Consult current base metal Coil & Flatsheet T.I.S. for additional information on the base metal and coating.
Not all materials and thicknesses are available from all locations. Contact Firestone Roof Solutions for additional information.

Manufacturing Locations: Anoka MN
College Park, GA
Jackson, MS
Miramar, FL
Morrisville, PA
Reno, NV
Warren, MI



This sheet is meant only to highlight Firestone's products and specifications. Information is subject to change without notice. Firestone takes responsibility for furnishing quality materials, which meet Firestone's published product specification. As neither Firestone itself nor its representatives practice architecture, Firestone offers no opinion on and expressly disclaims any responsibility for the soundness of any structure on which its products may be applied. If questions arise as to the soundness of a structure, or its ability to support a planned installation properly, the Owner should obtain opinions of competent structural engineers before proceeding. Firestone accepts no liability for any structural failure or for resultant damages, and no Firestone Representative is authorized to vary this disclaimer.

Firestone Building Products Company, LLC
250 West 96th Street • Indianapolis, IN 46260
Sales (800) 428-4442 • Technical (800) 428-4511
<http://www.firestonebpc.com>